

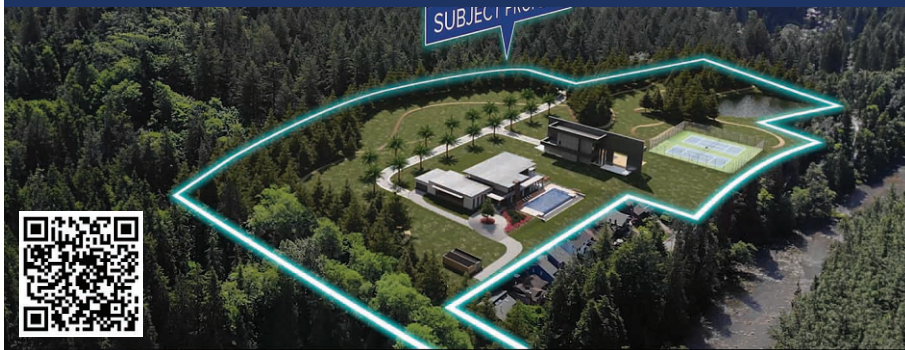

LOT 17 RIVERSIDE DRIVE 15.1 ACRE DEVELOPMENT SITE DISTRICT OF NORTH VANCOUVER

- Zoned RS1 for now - current zoning
- Potential for 6 houses or multi-family
- Note: rezoning can take 2-3 years
- Road access next to 1196 Riverside Drive
- Offered at \$10.6M

POTENTIAL EXECUTIVE MANSION WITH TENNIS COURT AND POOL



POTENTIAL: 6 DETACHED HOUSES



POTENTIAL: 2/3 RENTAL BUILDINGS



POTENTIAL: SINGLE HOME



OTHER DEVELOPMENT OPTIONS

www.lot17riversidedrive.com